

3
Fold this side of paper over to first paperfold on back of paper

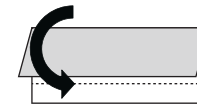

2
Unfold paper afterwards

4
Fold the paper you just folded one more time halving its size

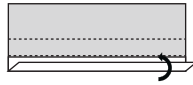

← Line 1 →

5
Fold this side over first paperfold covering half of the rulers back

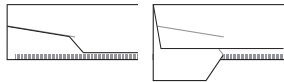
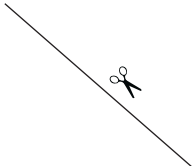
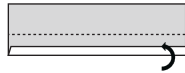

6
Lock the ruler by lifting the side flaps over and then under the paper

8
Cut or tear the 4 black lines, Do not cut through the ruler, but only through the folded paper



PrintARuler.com

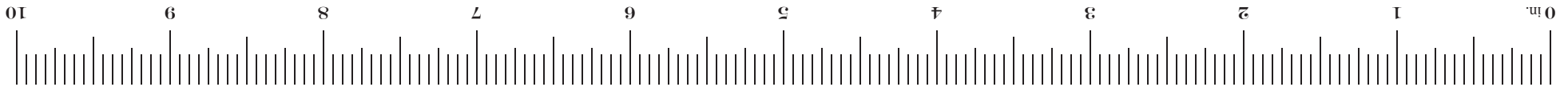

Cut from side of paper

Cut from side of paper

← Line 2 →

Ruler for US Letter size paper

Disable any page scaling and shrink options when printing

1
Fold this side of paper over to Line 1
Unfold paper afterwards



7
Fold this side over paperfold and up to the bottom of the vertical millimeter lines



6
Fold this side over to center of ruler on backside
Make sure the arrows point towards each other

